

# Available Industrial Site

## Scottsbluff/Gering, Nebraska

www.tcdne.org

### 3.6 & 3.8 Acres

#### Population

2014  
U.S. Census

Scottsbluff	14,875
Gering	8,491
Scotts Bluff County	36,465
Labor Market*	54,734
*Scotts Bluff County and contiguous counties	

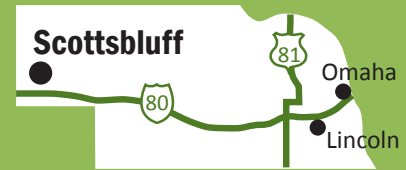

### BOUNDARIES

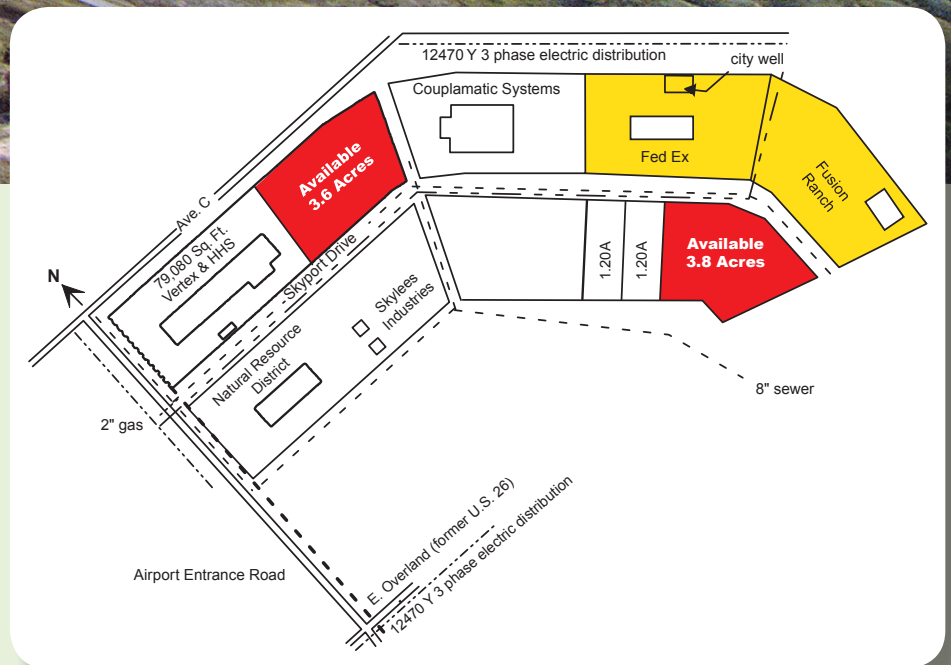

This information was received from sources whom we deem reliable; however, we do not guarantee accuracy. Prospective buyers should carefully verify all information.

©Nebraska Public Power District 388c836b A63

# Scottsbluff/Gering, Nebraska

## Site Description

Location .....	Skyport Industrial Park; 3 miles east of Scottsbluff
Size .....	3.6 & 3.8 acres
Characteristics .....	Level
Zoning .....	General Industrial
Present Use .....	Industrial site to be developed
Protective Services .....	Fire insurance classification is 3; 3.5 miles to a fire department with 17 full-time and 6 volunteer fire fighters, fire hydrants on site, 24-hour police patrol is provided

## Utilities

Electricity .....	Nebraska Public Power District; 7,200/12,500 kV wye, service voltage and transformation will be provided based on customer needs
Natural Gas .....	SourceGas; two 2" mains (looped system), 40 lbs. pressure; on site
Water .....	City of Scottsbluff; 8" and 12" mains on site, 55 lbs. static pressure, 36 lbs. residual pressure at 1,000 gal./min. on site; municipal water system has a maximum daily capacity of 19.3 million gal. and a daily peak of 11.2 million gal.
Sanitary Sewer .....	City of Scottsbluff; 8" and 12" mains on site; 24" main across highway on south end of site; extended aeration activated sludge plant has a rated capacity of 9 mgd with a peak demand of 3.8 mgd; storm drainage system
Telecommunications .....	Century Link; digital central office 3.5 miles from site, served by fiber ring; services available include T1/T3, ISDN, both BRI and PRI, Broadband; Century Link has an OC48 SONET ring in western Nebraska providing toll redundancy; POP available in Kimball, 40 miles south. Allo Communications has a fiber optic system to the Industrial Park

## Transportation

Highways .....	Four-lane Nebraska Highway 71 (will become part of Heartland Expressway) is 1.5 miles west of site; city is also served by U.S. Highway 26 (4-lane); Interstate 80 is approximately 40 miles south; Interstate 25 is 80 miles west; bus service available in Scottsbluff
Railroads .....	BNSF Railway Company branch line, 0.5 miles north of site; Union Pacific Railroad serves Gering, 2 miles south of Scottsbluff
Nearest Commercial Air Service .....	Western Nebraska Regional Airport; adjacent to site; 8,280' and 8,001' lighted, concrete runways; all-weather landing facilities; Great Lakes Aviation

## Other

Owner .....	TEM Development
Sale Price .....	\$25,000 to \$45,000 per lot
2015 Tax Rate .....	\$1.8332707 per \$100 of actual value

## Contacts

Rawnda Pierce, CPA  
Executive Director  
Twin Cities Development Assoc., Inc.  
1620 Broadway  
Scottsbluff, NE 69361  
(308) 632-2833  
Cell: (308) 641-1145  
Email: [twincitiesdev@tcdne.org](mailto:twincitiesdev@tcdne.org)  
[www.tcdne.org](http://www.tcdne.org)  
[www.wehavejobs.net](http://www.wehavejobs.net)



Rick J. Nelsen, CEcD  
Economic Development Manager  
Nebraska Public Power District  
PO Box 499  
Columbus, NE 68602-0499  
(800) 282-6773  
(402) 563-5534  
Email: [rjnelse@nppd.com](mailto:rjnelse@nppd.com)  
[econdev.nppd.com](http://econdev.nppd.com)